

# exkal

**e** FOR FUTURE GENERATIONS

## VITRINAS CRISTAL RECTO LOUVRE

**SOSTENIBLE Y MONOCASCO** / SUSTAINABLE AND MONOBLOCK /  
DURABLE ET MONOCOQUE / NACHHALTIG UND MONOBLOCK

**+** **VISIÓN PRODUCTO** / PRODUCT VISIBILITY / VISIBILITÉ PRODUITS /  
PRODUKPRÄSENTATION

**ERGONOMÍA** / ERGONOMY / ERGONOMIE / ERGONOMIE & DREHTÜR

**OPTIMIZACIÓN ESPACIO VENTA** / RETAIL FOOTPRINT  
OPTIMIZATION / RETAIL FOOTPRINT OPTIMISATION /  
VERKAUFSFLÄCHENOPTIMIERUNG

**+** **ÁREA TOTAL EXPOSICIÓN** / TOTAL DISPLAY AREA / TDA / TDA



## LOUVRE

VITRINAS REMOTOS

[exkalsa.com](http://exkalsa.com)

VITRINA CRISTAL RECTO / SERVE OVER STRAIGHT  
STRUCTURE / VITRINES STRUCTURE DROITE /  
VITRINEN GERADE GLASS

3M1

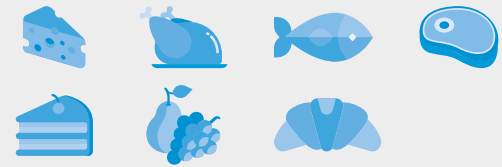

A T G F	1,5			2			3			4			5			6			C	CILÍNDRICO / CYLINDRICAL / CYLINDRIQUE / ZYLINDRISCH													
	937			1250			1875			2500			3125			3750				E90°			I90°			E45°			I45°				
mm	TDA	Vol	Suf	TDA	Vol	Suf	TDA	Vol	Suf	TDA	Vol	Suf	TDA	Vol	Suf	TDA	Vol	Suf	TDA	Vol	Suf	TDA	Vol	Suf	TDA	Vol	Suf	TDA	Vol	Suf	TDA	Vol	Suf
	m <sup>2</sup>	m <sup>3</sup>	m <sup>2</sup>	m <sup>2</sup>	m <sup>3</sup>	m <sup>2</sup>	m <sup>2</sup>	m <sup>3</sup>	m <sup>2</sup>	m <sup>2</sup>	m <sup>3</sup>	m <sup>2</sup>	m <sup>2</sup>	m <sup>3</sup>	m <sup>2</sup>	m <sup>2</sup>	m <sup>3</sup>	m <sup>2</sup>	m <sup>2</sup>	m <sup>3</sup>	m <sup>2</sup>	m <sup>2</sup>	m <sup>3</sup>	m <sup>2</sup>	m <sup>2</sup>	m <sup>3</sup>	m <sup>2</sup>	m <sup>2</sup>	m <sup>3</sup>	m <sup>2</sup>	m <sup>2</sup>	m <sup>3</sup>	m <sup>2</sup>
H1FWR1	0,91	198	1,04	1,21	264	1,39	1,82	396	2,08	2,43	528	2,78	3,04	660	3,47	3,65	792	4,17	-	-	-	-	-	-	-	-	-	-	-	-	-	-	-
H1FSR1	0,86	188	1	1,15	250	1,33	1,72	375	1,99	2,3	501	2,66	2,88	626	3,32	3,46	751	3,99	-	-	-	-	218	1	-	442	1,96	-	109	0,5	-	221	0,98
H1FMR1	0,81	177	0,94	1,09	237	1,27	1,63	355	1,9	2,18	473	2,54	2,72	591	3,17	3,27	710	3,81	-	-	-	-	213	0,96	-	411	1,8	-	107	0,48	-	206	0,9
H1FER1	0,76	167	0,9	1,02	223	1,21	1,54	334	1,81	2,05	446	2,42	2,57	557	3,02	3,09	668	3,63	-	-	-	-	209	0,96	-	381	1,68	-	105	0,48	-	190	0,84
H1SMR1	0,87	177	0,8	1,16	237	1,08	1,74	355	1,62	2,33	473	2,16	2,91	591	2,7	3,49	710	3,24	-	-	-	-	213	0,96	-	411	1,8	-	107	0,48	-	206	0,9
H1SER1	0,83	167	0,76	1,1	223	1,02	1,65	334	1,53	2,2	446	2,04	2,75	557	2,55	3,3	668	3,06	-	-	-	-	209	0,96	-	381	1,68	-	105	0,48	-	190	0,84

TDA = Área Total de Exposición / Total Display Area / Zone d'affichage totale / Gesamtausstellungsfläche • Vol = Volumen neto / Net volume / Volume net / Nettovolumen • Suf = Superficie de exposición / Exhibition surface / Surface d'exposition / Ausstellungsfläche.  
Best energy class model. More information at EPREL or contact our Sales Department.



mm	1,5			2			3			4			5			6			C			CILÍNDRICO / CYLINDRICAL / CYLINDRIQUE / ZYLINDRISCH													
	937			1250			1875			2500			3125			3750						E90°			190°			E45°			145°				
	TDA	Vol	Suf	TDA	Vol	Suf	TDA	Vol	Suf	TDA	Vol	Suf	TDA	Vol	Suf	TDA	Vol	Suf	TDA	Vol	Suf	TDA	Vol	Suf	TDA	Vol	Suf	TDA	Vol	Suf	TDA	Vol	Suf	TDA	Vol
	m <sup>2</sup>	m <sup>3</sup>	m <sup>2</sup>	m <sup>2</sup>	m <sup>3</sup>	m <sup>2</sup>	m <sup>2</sup>	m <sup>3</sup>	m <sup>2</sup>	m <sup>2</sup>	m <sup>3</sup>	m <sup>2</sup>	m <sup>2</sup>	m <sup>3</sup>	m <sup>2</sup>	m <sup>2</sup>	m <sup>3</sup>	m <sup>2</sup>	m <sup>2</sup>	m <sup>3</sup>	m <sup>2</sup>	m <sup>2</sup>	m <sup>3</sup>	m <sup>2</sup>	m <sup>2</sup>	m <sup>3</sup>	m <sup>2</sup>	m <sup>2</sup>	m <sup>3</sup>	m <sup>2</sup>	m <sup>2</sup>	m <sup>3</sup>	m <sup>2</sup>		
<b>F</b> HIASR1	0,94	188	1	1,25	250	1,33	1,88	375	1,99	2,5	501	2,66	3,13	626	3,32	3,75	751	3,99	-	-	-	-	218	1	-	442	1,96	-	109	0,5	-	221	0,98		
H1AMR1	0,89	177	0,94	1,19	237	1,27	1,78	355	1,9	2,38	473	2,54	2,97	591	3,17	3,56	710	3,81	-	-	-	-	213	0,96	-	411	1,8	-	107	0,48	-	206	0,9		
H1AER1	0,84	167	0,9	1,13	223	1,21	1,69	334	1,81	2,25	446	2,42	2,81	557	3,02	3,38	668	3,63	-	-	-	-	209	0,96	-	381	1,68	-	105	0,48	-	190	0,84		
H1AIR1	0,7	136	0,76	0,94	182	1,01	1,41	272	1,51	1,88	363	2,02	2,34	454	2,52	2,81	545	3,03	-	-	-	-	-	-	-	-	-	-	-	-	-	-	-		
HDHER1	-	-	-	2,5	729	2,04	3,75	1094	3,06	5	1458	4,08	-	-	-	7,5	2187	6,12	2	479	1,23	-	-	-	-	-	-	-	-	-	-	-	-		
HDHCR1	-	-	-	2,25	639	1,76	3,38	959	2,64	4,5	1278	3,52	-	-	-	6,75	1917	5,28	1,82	428	1,11	-	-	-	-	-	-	-	-	-	-	-	-	-	
HDHQRI	-	-	-	1,88	504	1,4	2,81	756	2,1	3,75	1008	2,8	-	-	-	5,63	1512	4,2	1,55	351	0,88	-	-	-	-	-	-	-	-	-	-	-	-	-	
HDLER1	-	-	-	2,4	446	2,04	3,6	668	3,06	4,8	891	4,08	-	-	-	7,2	1337	6,12	1,87	293	1,23	-	-	-	-	-	-	-	-	-	-	-	-	-	
HDLCR1	-	-	-	2,15	391	1,76	3,23	586	2,64	4,3	781	3,52	-	-	-	6,45	1172	5,28	1,7	262	1,11	-	-	-	-	-	-	-	-	-	-	-	-	-	
HDLQRI	-	-	-	1,78	308	1,4	2,66	462	2,1	3,55	616	2,8	-	-	-	5,33	924	4,2	1,44	215	0,88	-	-	-	-	-	-	-	-	-	-	-	-	-	
<b>E</b> SHDHER1	-	-	-	2,32	729	2,04	3,39	1094	3,06	4,45	1458	4,08	-	-	-	6,95	2187	6,12	1,85	480	1,23	-	-	-	-	-	-	-	-	-	-	-	-	-	
SHDHR1	-	-	-	2,09	639	1,76	3,13	959	2,64	4,13	1278	3,52	-	-	-	6,26	2187	5,28	1,69	428	1,11	-	-	-	-	-	-	-	-	-	-	-	-	-	
SHDLER1	-	-	-	2,22	445	2,04	3,24	668	3,06	4,25	890	4,08	-	-	-	6,65	1335	6,12	1,8	293	1,23	-	-	-	-	-	-	-	-	-	-	-	-	-	
SHDLCR1	-	-	-	2	391	1,76	3	586	2,64	3,99	781	3,52	-	-	-	5,98	1172	5,28	1,58	262	1,11	-	-	-	-	-	-	-	-	-	-	-	-	-	

TDA = Área Total de Exposición / Total Display Area / Zone d'affichage totale / Gesamtausstellungsfläche • Vol = Volumen neto / Net volume / Volume net / Nettovolumen • Suf = Superficie de exposición / Exhibition surface / Surface d'exposition / Ausstellungsfläche.  
**Best energy class model. More information at EPREL or contact our Sales Department.**

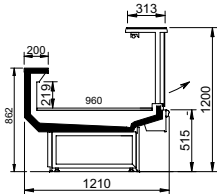

H1FWR1

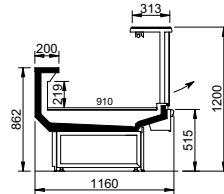

H1FSR1

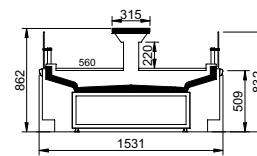

HDLQR1

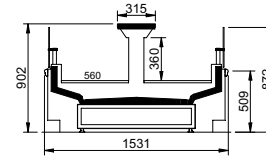

HDHQR1

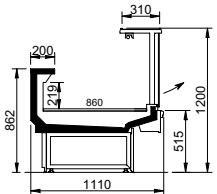

H1FMR1

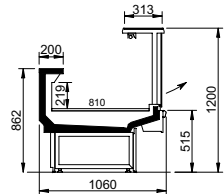

H1FER1

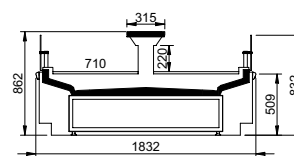

HDLCR1

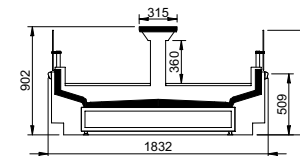

HDHCR1

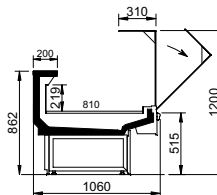

H1SER1

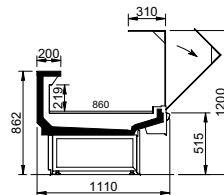

H1SMR1

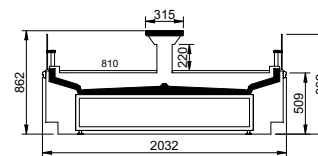

HDLER1

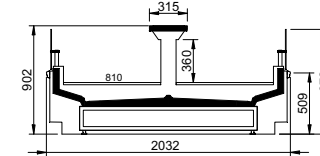

HDHER1

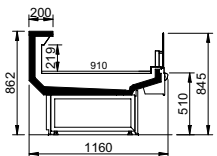

H1ASR1

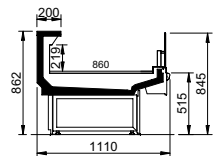

H1AMR1

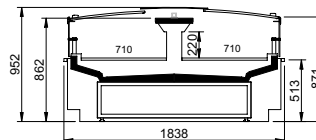

SHDLCR1

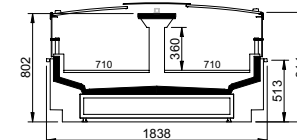

SHDHCR1

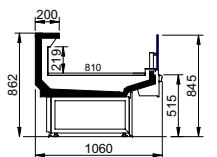

H1AER1

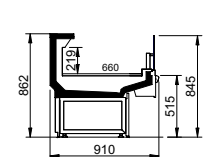

H1AIR1

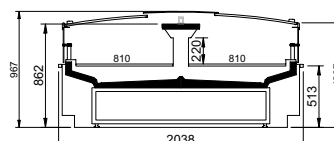

SHDLR1

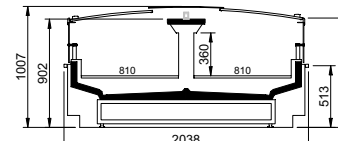

SHDHER1

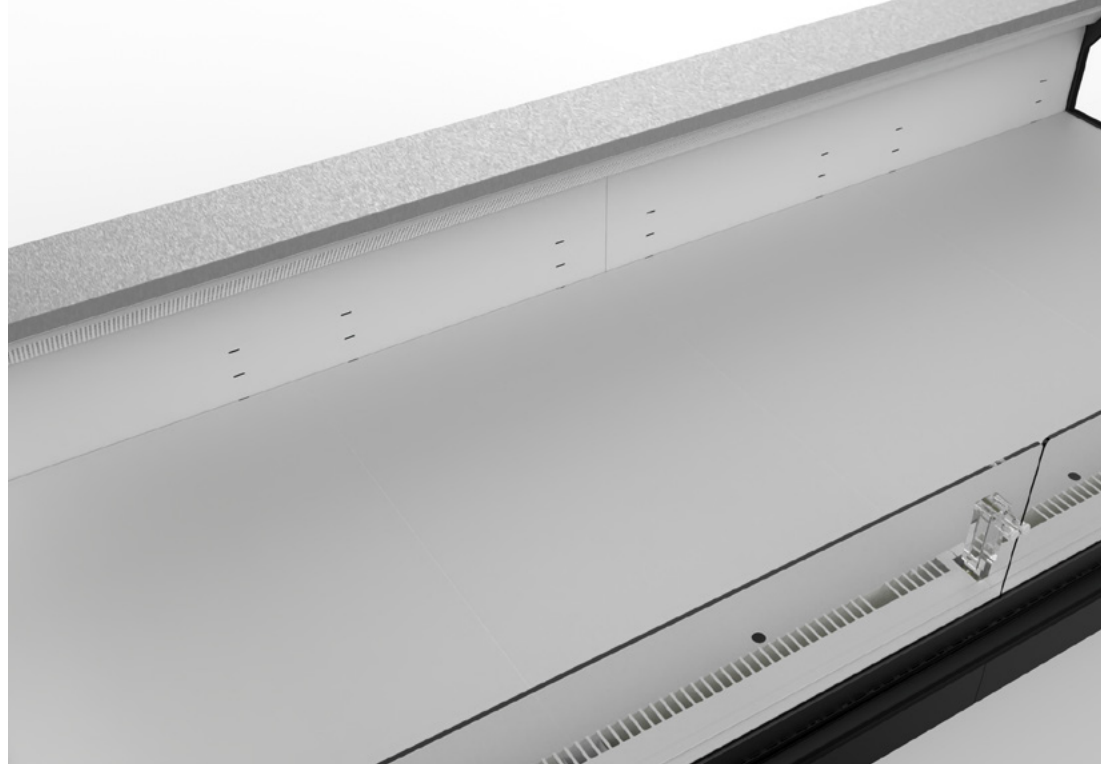
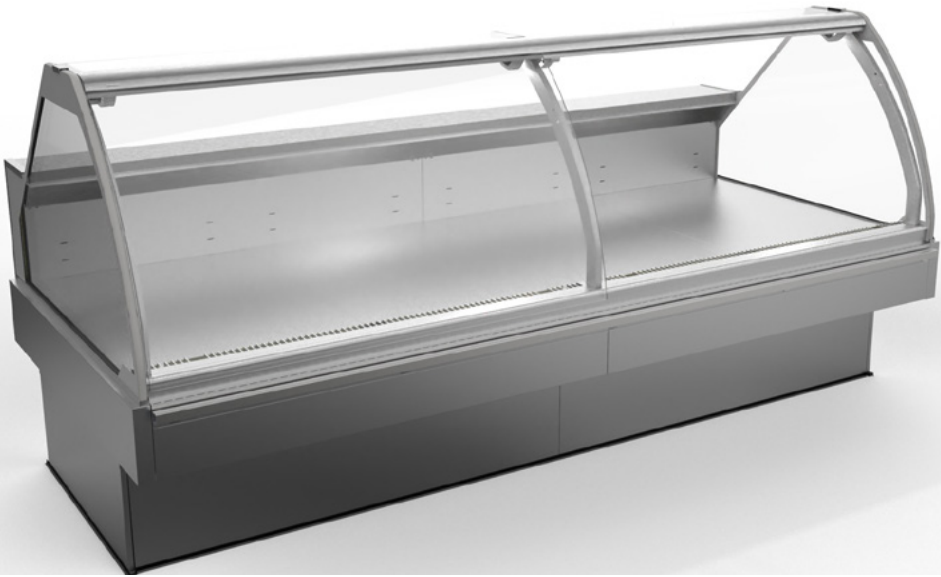

EVAPORATOR

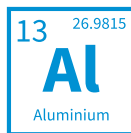
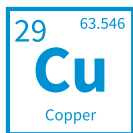
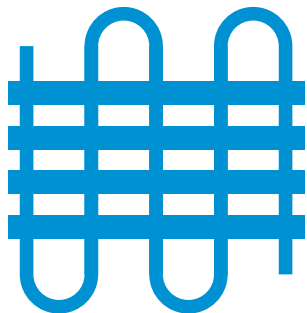

MONOBLOCK



# exkal

FOR FUTURE GENERATIONS

Pol. Ind. El Campillo, C/A N° 1, 31340, Marcilla, Navarra  
(España - Spain)

+34 948 708 292 | [exkalsa@exkalsa.com](mailto:exkalsa@exkalsa.com) | [exkalsa.com](http://exkalsa.com)

**exkal**  
CONCEPT

[exkalconcept.com](http://exkalconcept.com)

**horexkal**  
| | | |

[horexkal.com](http://horexkal.com)



  
**OBJETIVOS  
DE DESARROLLO  
SOSTENIBLE**



**AENOR**  
GESTIÓN DE LA CALIDAD  
ISO 9001  
EP-0549/0011

**AENOR**  
GESTIÓN AMBIENTAL  
ISO 14001  
GA-2011/0074

**AENOR**  
SEGURIDAD Y SALUD EN EL TRABAJO  
OHSAS 18001  
SST-0003/0011

**AENOR**  
SOCIAL RESPONSABILITY  
ISO 26001  
SR-0009/45

**AENOR**  
SEGURIDAD INFORMACIÓN  
ISO 27001  
SI-0011/0021

**AENOR**  
GESTIÓN ENERGÉTICA  
ISO 50001  
GE-2002/0091

**AENOR**  
SEGURIDAD Y SALUD EN EL TRABAJO  
ISO 45001  
SST-0012/0011

**AENOR**  
RESIDUO CERO  
ISO 14001  
RC-2004/0006

 **CERTICOLD**  
HACCP



  
**AEFYT**  
ASOCIACIÓN DE EMPRESAS DE FIBRO Y SUS TECNOLOGÍAS

 **EUREKA**

 **CHINEKA**





 **AFFILIATED MANUFACTURER  
EUROVENT**

