

exkal

e FOR FUTURE GENERATIONS

GAMA 1

SEMIMURALES VITRINA GAMA 1 MONTMARTRE

GAMA 1 / RANGE 1 / GAMME 1 / BEREICH 1

SOSTENIBLE Y MONOCASCO / SUSTAINABLE AND MONOBLOCK /
DURABLE ET MONOCOQUE / NACHHALTIG UND MONOBLOCK

+ **VISIÓN PRODUCTO** / PRODUCT VISIBILITY / VISIBILITÉ PRODUITS /
PRODUKPRÄSENTATION

ERGONOMÍA / ERGONOMY / ERGONOMIE / ERGONOMIE & DREHTÜR

OPTIMIZACIÓN ESPACIO VENTA / RETAIL FOOTPRINT
OPTIMIZATION / RETAIL FOOTPRINT OPTIMISATION /
VERKAUFSFLÄCHENOPTIMIERUNG

+ **ÁREA TOTAL EXPOSICIÓN** / TOTAL DISPLAY AREA / TDA / TDA



MONTMARTRE
SEMIMURALES VITRINA **REMOTOS**

exkalsa.com

GAMA 1

SEMIMURALES DE VITRINA /
LOW MULTIDECKS SERVE
OVER TYPE / SEMI
VERTICAUX DE VITRINE /
SEMI VERTIKALE VITRINEN

3M2

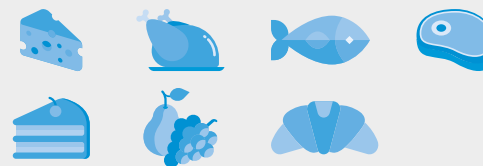

GAMA 1 / RANGE 1 / GAMME 1 / BEREICH 1

mm	1			1,5			2			3			4			6			C		
	625			937			1250			1875			2500			3750					
	TDA	Vol	Suf	TDA	Vol	Suf	TDA	Vol	Suf	TDA	Vol	Suf	TDA	Vol	Suf	TDA	Vol	Suf	TDA	Vol	Suf
	m ²	L	m ²	m ²	L	m ²	m ²	L	m ²	m ²	L	m ²	m ²	L	m ²	m ²	L	m ²	m ²	l	m ²
L1LIM1	-	-	-	0,86	244	1,00	1,15	325	1,35	1,73	488	2,02	2,3	650	2,70	3,45	975	4,05	2,26	489	2,15
L1LNM1	0,64	181	0,80	0,96	272	1,20	1,28	363	1,60	1,91	544	2,40	2,55	725	3,20	3,83	1088	4,80	2,46	547	2,43
L1LMM1	0,7	206	0,89	1,05	309	1,35	1,4	413	1,78	2,1	619	2,68	2,8	825	3,56	4,2	1238	5,34	2,67	605	2,66
L1MNM1	0,76	238	0,99	1,14	356	1,49	1,53	475	1,99	2,29	713	2,98	3,05	950	3,98	4,58	1425	5,97	3,02	717	3,01
L1MMM1	0,83	269	1,08	1,24	403	1,64	1,65	538	2,17	2,48	806	3,26	3,3	1075	4,34	4,95	1613	6,51	3,27	793	3,30
L1HNM2	0,86	281	1,22	1,28	422	1,82	1,71	563	2,44	2,57	844	3,64	3,43	1125	4,88	5,14	1688	7,32	3,43	849	3,71
L1HNM2 1980	-	-	-	-	-	-	-	-	-	-	-	-	4	1650	6,40	6	2475	9,60	-	-	-
L1HMM2	0,92	313	1,34	1,38	469	2,02	1,84	625	2,69	2,76	938	4,02	3,68	1250	5,38	5,51	1875	8,07	3,7	939	4,06
SL1MNM1	-	-	-	-	-	-	1,31	525	2,05	1,97	788	3,08	2,63	1050	4,10	3,94	1575	6,15	2,78	793	3,11
L1DLCM1	-	-	-	-	-	-	2,4	688	2,78	3,6	1031	4,16	4,8	1375	5,56	7,2	2063	8,34	2,23	481	2,13
L1DLEM1	-	-	-	-	-	-	2,65	763	3,20	3,98	1144	4,78	5,3	1525	6,40	7,95	2288	9,60	2,43	539	2,38
L1DMCM1	-	-	-	-	-	-	2,9	888	3,94	4,35	1331	5,92	5,8	1775	7,40	8,7	2663	11,82	2,74	630	2,73
L1DHCM2	-	-	-	-	-	-	3,28	1050	4,72	4,91	1575	7,04	6,55	2100	9,44	9,83	3150	14,16	3,11	746	3,25
SL1DMCM1	-	-	-	-	-	-	2,48	975	3,94	3,71	1463	5,92	4,95	1950	7,40	7,43	2925	11,82	2,54	696	2,73

TDA = Área Total de Exposición / Total Display Area / Zone d'affichage totale / Gesamtausstellungsfläche • Vol = Volumen neto / Net volume / Volume net / Nettovolumen • Suf = Superficie de exposición / Exhibition surface / Surface d'exposition / Ausstellungsfläche.
Best energy class model. More information at EPREL or contact our Sales Department.



SECCIONES / SECTIONS / SECTIONS / SCHNITTE

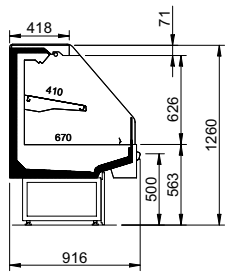

L1LIM1-

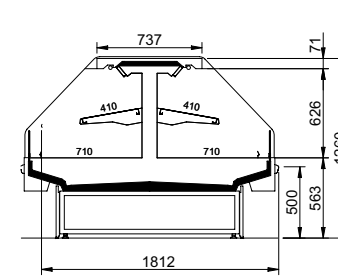

L1DLCM1-

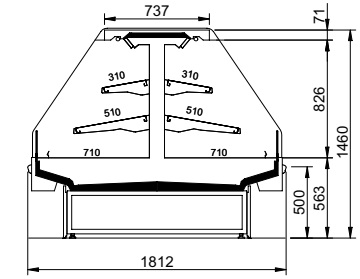

L1DMCM1-

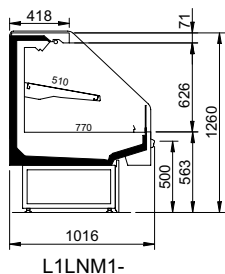

L1LNM1-

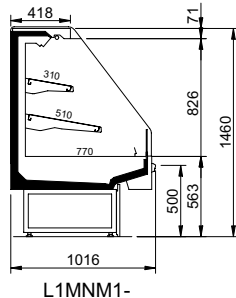

L1MNM1-

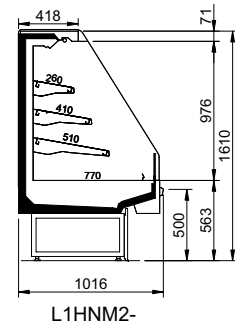

L1HNM2-

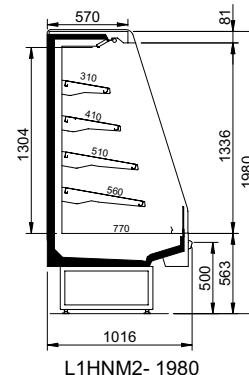

L1HNM2- 1980

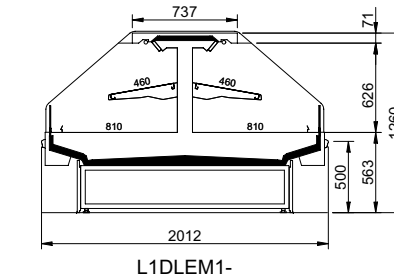

L1DLEM1-

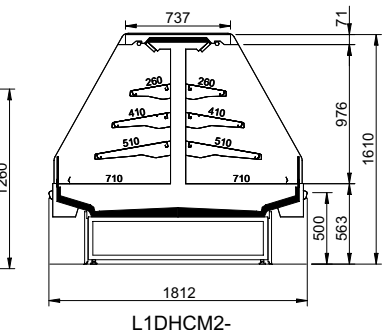

L1DHCM2-

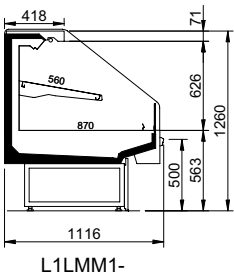

L1LMM1-

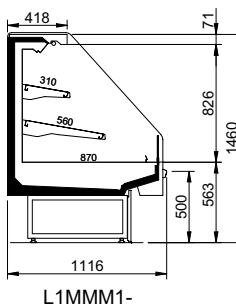

L1MMM1-

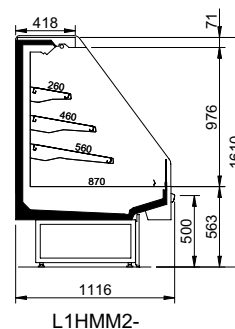

L1HMM2-

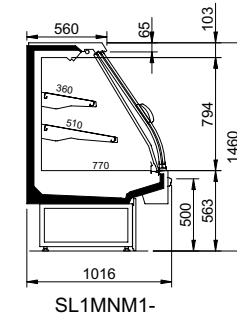

SL1MM1-

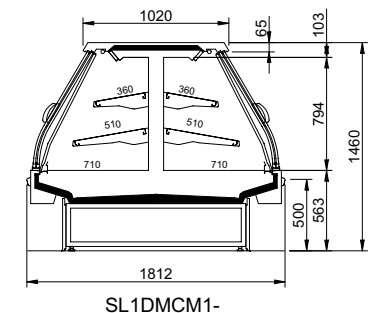

SL1DMCM1-

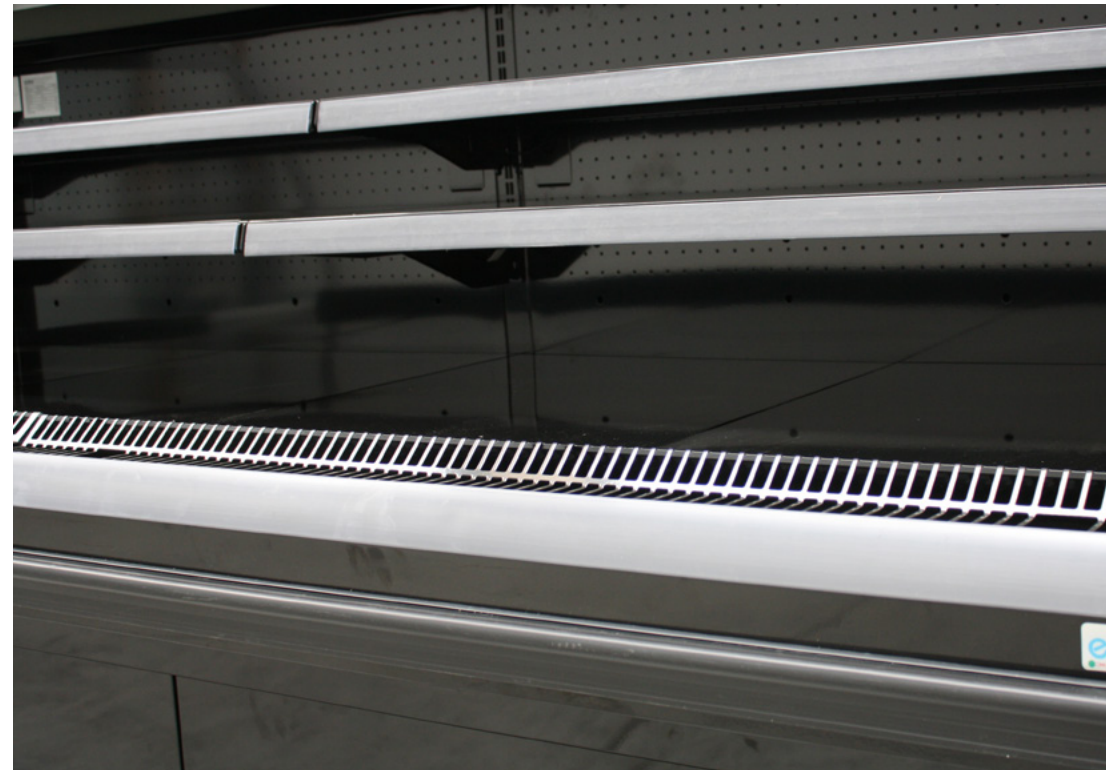
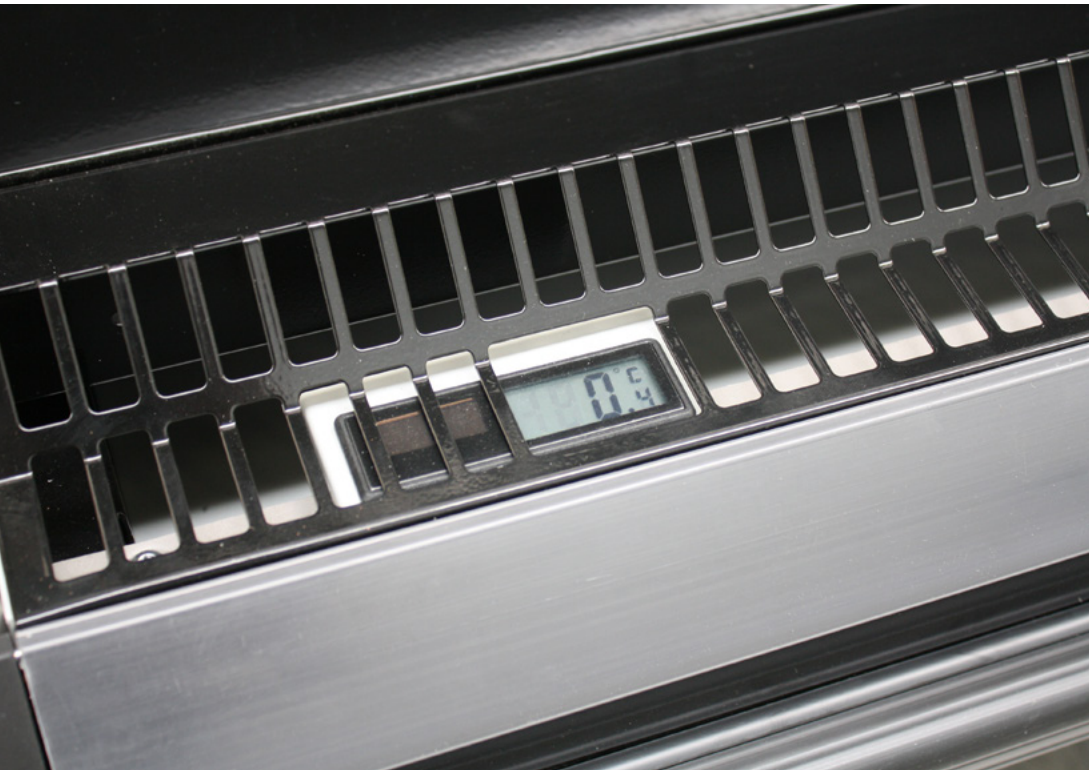

EVAPORATOR

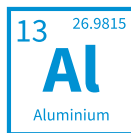
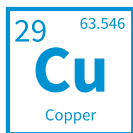
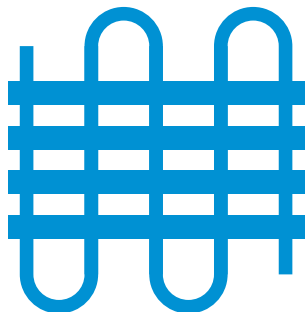

MONOBLOCK



exkal

FOR FUTURE GENERATIONS

Pol. Ind. El Campillo, C/A N° 1, 31340, Marcilla, Navarra
(España - Spain)

+34 948 708 292 | exkalsa@exkalsa.com | exkalsa.com

exkal
CONCEPT

exkalconcept.com

horexkal
| | | | |

horexkal.com



**OBJETIVOS
DE DESARROLLO
SOSTENIBLE**



AENOR
GESTIÓN DE LA CALIDAD
ISO 9001
EK-0549/0011

AENOR
GESTIÓN AMBIENTAL
ISO 14001
GA2011/0074

AENOR
SEGURIDAD Y SALUD EN EL TRABAJO
OHSAS 18001
SST-0003/0011

AENOR
SOCIAL RESPONSABILITY
ISO 26001
SR-0009/45

AENOR
SEGURIDAD INFORMACIÓN
ISO/IEC 27001
SI-0011/0021

AENOR
GESTIÓN ENERGÉTICA
ISO 50001
GE-0002/0001

AENOR
SEGURIDAD Y SALUD EN EL TRABAJO
ISO 45001
SST-0002/0011

AENOR
RESIDUO CERO
ISO 14001
RC2004/0006

CERTICOLD
HACCP



AEFYT
ASOCIACIÓN DE EMPRESAS DE FIBRO Y SUS TECNOLOGÍAS

EUREKA

CHINEKA





AFFILIATED MANUFACTURER
EUROVENT

