

# exkal

**e** FOR FUTURE GENERATIONS

**GAMA 1**

## SEMIMURALES VITRINA GAMA 1 MONTMARTRE

**GAMA 1** / RANGE 1 / GAMME 1 / BEREICH 1

**SOSTENIBLE Y MONOCASCO** / SUSTAINABLE AND MONOBLOCK /  
DURABLE ET MONOCOQUE / NACHHALTIG UND MONOBLOCK

**+** **VISIÓN PRODUCTO** / PRODUCT VISIBILITY / VISIBILITÉ PRODUITS /  
PRODUKPRÄSENTATION

**ERGONOMÍA** / ERGONOMY / ERGONOMIE / ERGONOMIE & DREHTÜR

**OPTIMIZACIÓN ESPACIO VENTA** / RETAIL FOOTPRINT  
OPTIMIZATION / RETAIL FOOTPRINT OPTIMISATION /  
VERKAUFSFLÄCHENOPTIMIERUNG

**+** **ÁREA TOTAL EXPOSICIÓN** / TOTAL DISPLAY AREA / TDA / TDA



**MONTMARTRE**  
SEMIMURALES VITRINA REMOTOS

[exkalsa.com](http://exkalsa.com)

# GAMA 1

SEMIMURALES DE VITRINA /  
LOW MULTIDECKS SERVE  
OVER TYPE / SEMI  
VERTICAUX DE VITRINE /  
SEMI VERTIKALE VITRINEN

## 3M2

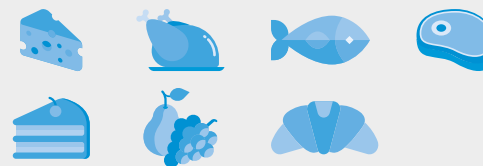

### GAMA 1 / RANGE 1 / GAMME 1 / BEREICH 1

mm	1			1,5			2			3			4			6			C		
	TDA	Vol	Suf	TDA	Vol	Suf	TDA	Vol	Suf	TDA	Vol	Suf	TDA	Vol	Suf	TDA	Vol	Suf	TDA	Vol	Suf
	m <sup>2</sup>	L	m <sup>2</sup>	m <sup>2</sup>	L	m <sup>2</sup>	m <sup>2</sup>	L	m <sup>2</sup>	m <sup>2</sup>	L	m <sup>2</sup>	m <sup>2</sup>	L	m <sup>2</sup>	m <sup>2</sup>	L	m <sup>2</sup>	m <sup>2</sup>	l	m <sup>2</sup>
L1LIM1	-	-	-	0,86	244	1,00	1,15	325	1,35	1,73	488	2,02	2,3	650	2,70	3,45	975	4,05	2,26	489	2,15
L1LNM1	0,64	181	0,80	0,96	272	1,20	1,28	363	1,60	1,91	544	2,40	2,55	725	3,20	3,83	1088	4,80	2,46	547	2,43
L1LMM1	0,7	206	0,89	1,05	309	1,35	1,4	413	1,78	2,1	619	2,68	2,8	825	3,56	4,2	1238	5,34	2,67	605	2,66
L1MIM1	-	-	-	1,05	319	1,29	1,4	425	1,74	2,1	638	2,60	2,8	850	3,48	4,2	1275	5,22	2,78	641	2,67
<b>D</b> L1MNM1	0,76	238	0,99	1,14	356	1,49	1,53	475	1,99	2,29	713	2,98	3,05	950	3,98	4,58	1425	5,97	3,02	717	3,01
L1MMM1	0,83	269	1,08	1,24	403	1,64	1,65	538	2,17	2,48	806	3,26	3,3	1075	4,34	4,95	1613	6,51	3,27	793	3,30
L1HIM3	-	-	-	1,19	375	1,54	1,59	500	2,07	2,38	750	3,10	3,18	1000	4,14	4,76	1500	6,21	3,15	759	3,29
L1HNM2	0,86	281	1,22	1,28	422	1,82	1,71	563	2,44	2,57	844	3,64	3,43	1125	4,88	5,14	1688	7,32	3,43	849	3,71
L1HMM2	0,92	313	1,34	1,38	469	2,02	1,84	625	2,69	2,76	938	4,02	3,68	1250	5,38	5,51	1875	8,07	3,7	939	4,06
SL1MIM1	-	-	-	-	-	-	1,31	425	1,74	1,97	638	2,60	2,63	850	3,48	3,94	1275	5,22	2,57	709	2,75
<b>B</b> SL1MNM1	-	-	-	-	-	-	1,31	525	2,05	1,97	788	3,08	2,63	1050	4,10	3,94	1575	6,15	2,78	793	3,11
SL1MMM1	-	-	-	-	-	-	1,31	625	2,29	1,97	938	3,44	2,63	1250	4,58	3,94	1875	6,87	2,99	877	3,42

TDA = Área Total de Exposición / Total Display Area / Zone d'affichage totale / Gesamtausstellungsfläche • Vol = Volumen neto / Net volume / Volume net / Nettovolumen • Suf = Superficie de exposición / Exhibition surface / Surface d'exposition / Ausstellungsfläche.  
Best energy class model. More information at EPREL or contact our Sales Department.



**GAMA 1 / RANGE 1 / GAMME 1 / BEREICH 1**

	1			1,5			2			3			4			6			C		
mm	625			937			1250			1875			2500			3750					
	TDA	Vol	Suf	TDA	Vol	Suf	TDA	Vol	Suf	TDA	Vol	Suf	TDA	Vol	Suf	TDA	Vol	Suf	TDA	Vol	Suf
	m <sup>2</sup>	L	m <sup>2</sup>	m <sup>2</sup>	L	m <sup>2</sup>	m <sup>2</sup>	L	m <sup>2</sup>	m <sup>2</sup>	L	m <sup>2</sup>	m <sup>2</sup>	L	m <sup>2</sup>	m <sup>2</sup>	L	m <sup>2</sup>	m <sup>2</sup>	L	m <sup>2</sup>
LIDLPM1	-	-	-	-	-	-	2,15	600	2,54	3,23	900	3,80	4,3	1200	5,08	6,45	1800	7,62	2,03	423	1,86
LIDLPM1	-	-	-	-	-	-	2,4	688	2,78	3,6	1031	4,16	4,8	1375	5,56	7,2	2063	8,34	2,23	481	2,13
LIDLEM1	-	-	-	-	-	-	2,65	763	3,20	3,98	1144	4,78	5,3	1525	6,40	7,95	2288	9,60	2,43	539	2,38
LIDMPM1	-	-	-	-	-	-	2,65	788	3,20	3,98	1181	4,76	5,3	1575	6,40	7,95	2363	9,60	2,5	554	2,31
LIDMCM1	-	-	-	-	-	-	2,9	888	3,94	4,35	1331	5,92	5,8	1775	7,40	8,7	2663	11,82	2,74	630	2,73
LIDMEM1	-	-	-	-	-	-	3,15	1000	4,46	4,73	1500	6,70	6,3	2000	8,92	9,45	3000	13,38	2,99	706	3,04
LIDHPM3	-	-	-	-	-	-	3,03	925	4,10	4,54	1388	6,12	6,05	1850	8,20	9,08	2775	12,30	2,84	656	2,84
LIDHCM2	-	-	-	-	-	-	3,28	1050	4,72	4,91	1575	7,04	6,55	2100	9,44	9,83	3150	14,16	3,11	746	3,25
LIDHEM2	-	-	-	-	-	-	3,53	1175	5,26	5,29	1763	7,86	7,05	2350	10,52	10,58	3525	15,78	3,38	836	3,62
SLIDMPM1	-	-	-	-	-	-	2,48	788	3,20	3,71	1181	4,76	4,95	1575	6,40	7,43	2363	9,60	2,33	612	2,38
SLIDMCM1	-	-	-	-	-	-	2,48	975	3,94	3,71	1463	5,92	4,95	1950	7,40	7,43	2925	11,82	2,54	696	2,73
SLIDMEM1	-	-	-	-	-	-	2,48	1175	4,46	3,71	1763	6,70	4,95	2350	8,92	7,43	3525	13,38	2,75	780	3,04

AIG D

AIG B

TDA = Área Total de Exposición / Total Display Area / Zone d'affichage totale / Gesamtausstellungsfläche • Vol = Volumen neto / Net volume / Volume net / Nettovolumen • Suf = Superficie de exposición / Exhibition surface / Surface d'exposition / Ausstellungsfläche.  
**Best energy class model. More information at EPREL or contact our Sales Department.**

SECCIONES / SECTIONS / SECTIONS / SCHNITTE

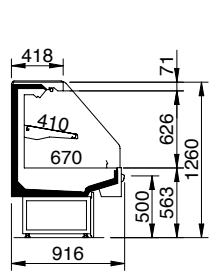

L1LIM1-

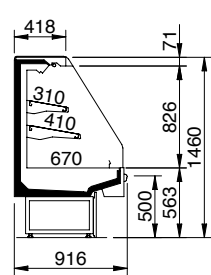

LIMIM1-

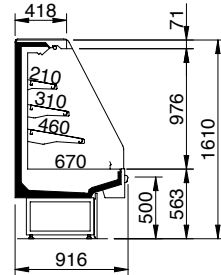

L1HIM1-

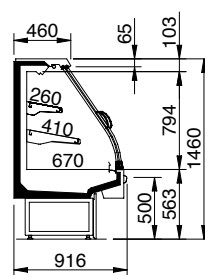

SLIMIM1-

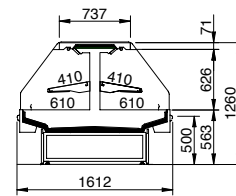

L1DLPM1-

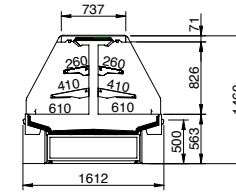

L1DMPM1-

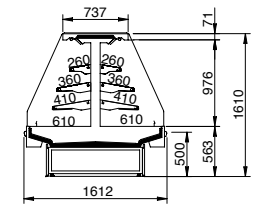

L1DHPM1-

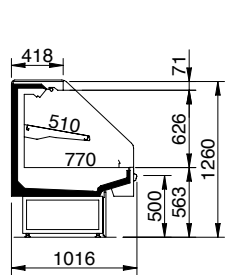

L1LNM1-

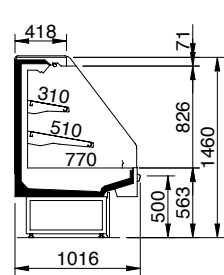

LIMNM1-

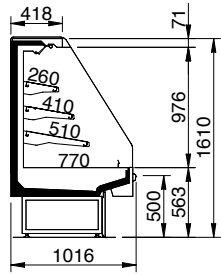

L1HNM1-

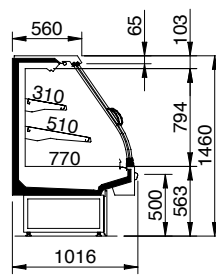

SLIMNM1-

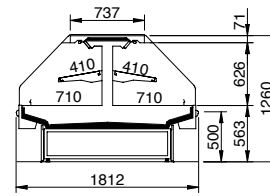

L1DLCM1-

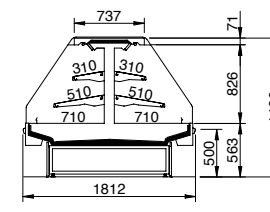

L1DMCM1-

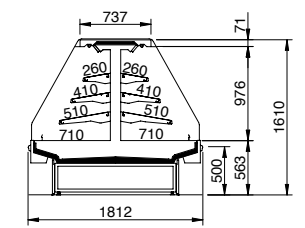

L1DHCM1-

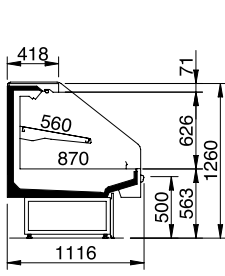

L1LMM1-

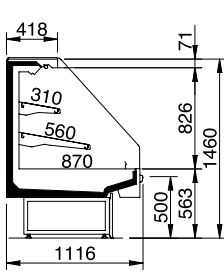

LIMMM1-

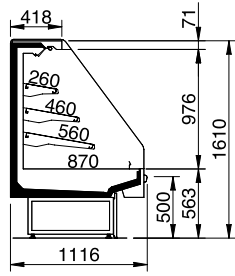

L1HMM1-

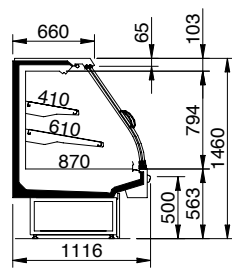

SLIMMM1-

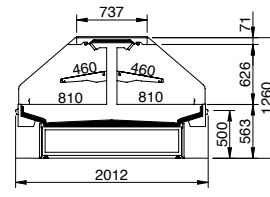

L1DLEM1-

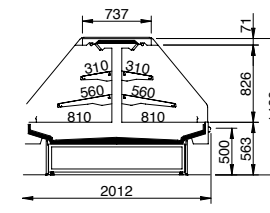

L1DMEM1-

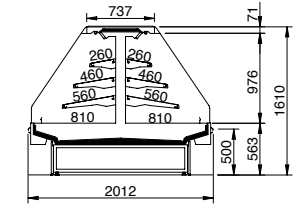

L1DHEM1-

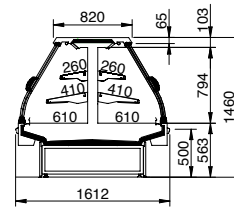

SL1DMPM1-

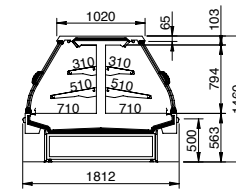

SL1DMCM1-

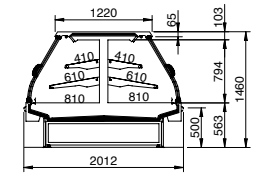

SL1DMEM1-

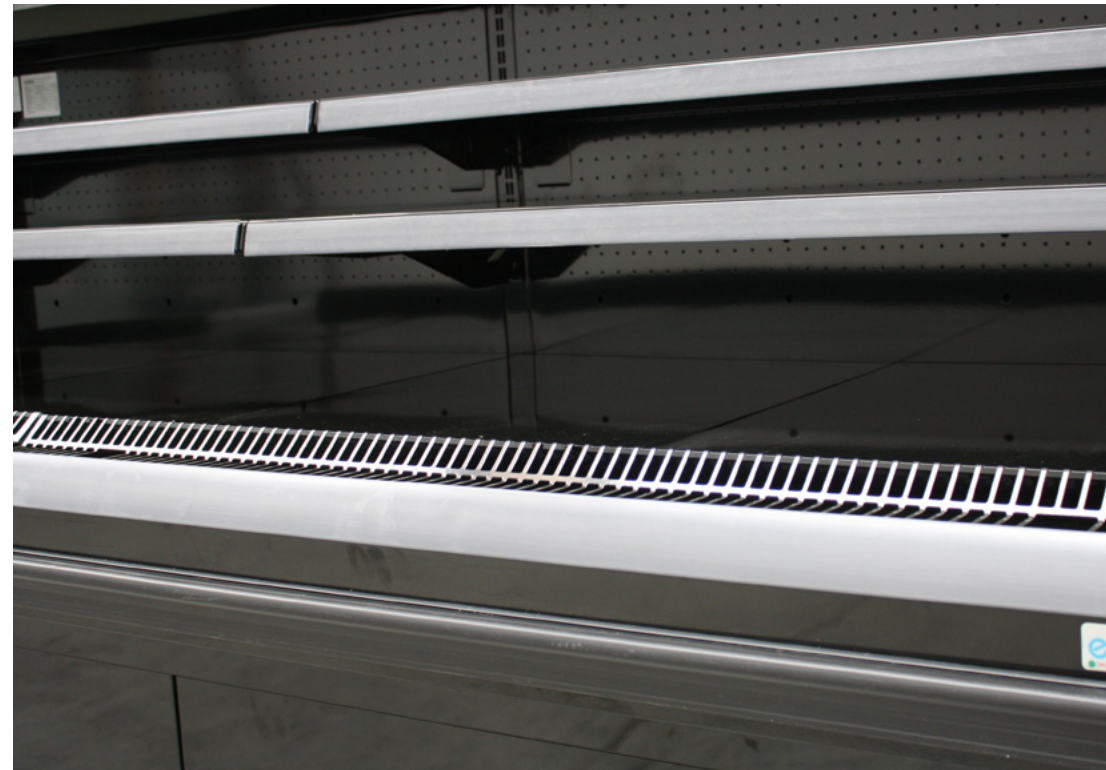

EVAPORATOR

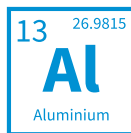
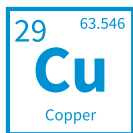
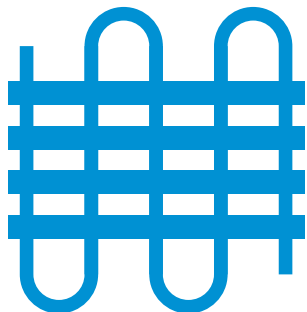

MONOBLOCK



# exkal

FOR FUTURE GENERATIONS

Pol. Ind. El Campillo, C/A N° 1, 31340, Marcilla, Navarra  
(España - Spain)

+34 948 708 292 | [exkalsa@exkalsa.com](mailto:exkalsa@exkalsa.com) | [exkalsa.com](http://exkalsa.com)

**exkal**  
CONCEPT

[exkalconcept.com](http://exkalconcept.com)

**horexkal**  
| | | |

[horexkal.com](http://horexkal.com)



  
**OBJETIVOS  
DE DESARROLLO  
SOSTENIBLE**



**AENOR**  
GESTIÓN  
DE LA CALIDAD  
ISO 9001  
EK-049/0011

**AENOR**  
GESTIÓN  
AMBIENTAL  
ISO 14001  
GA-0011/0074

**AENOR**  
SEGURIDAD Y SALUD  
EN EL TRABAJO  
OHSAS 18001  
ST-002/0011

**AENOR**  
SOCIAL  
RESPONSABILITY  
ISO 26000  
SR-000/0045

**AENOR**  
SEGURIDAD  
INFORMACIÓN  
ISO/IEC 27001  
SK-0011/0021

**AENOR**  
GESTIÓN  
ENERGÉTICA  
ISO 50001  
GE-002/0009

 **CERTICOLD**  
HACCP



  
**AEFYT**  
ASOCIACIÓN DE EMPRESAS DE FIBRO  
Y SUS TECNOLOGÍAS

  
**EUREKA**

  
**CHINEKA**

  
生产许可

  
**ICNet**

  
AFFILIATED MANUFACTURER  
**EUROVENT**

